



# Tyr

Making the dream a reality for all house owners with direct-acting electricity or a heat pump.

## Can use both pellets and firewood

Tyr is a fully automatic pellet stove. This means that it'll be nice and warm inside when you come home. The Tyr doesn't need to be supervised, it's controlled via a thermostat placed in a strategic location in the house to ensure optimum heat dissipation.

In terms of capacity, Tyr distributes heat to most of your house, depending on how the rooms are arranged.

## Why buy a Tyr?

Tyr uses tried and tested pellet technology combined with Nordic design.

The Tyr is equipped with an underfeed pellet burner, which means reliable operation, greater efficiency and easier servicing.

There's a separate store for pellets, either at the side or behind the stove in another room – simply choose the solution that suits you best.

Works with both 6 mm and 8 mm pellets.

You can also burn firewood.

Thermostat control with the option of setting the temperatures required for different times, e.g. night-time mode etc.

Lower heating costs without investing in a water-borne system.

### Extra equipment:

- Flue gas damper (requirement)
- Soapstone
- Chimney components
- EcoVacMini ash vacuum
- Chimney liner, depending on age and condition.

## Ash and combustion

Heating with a Tyr is very similar to heating with other modern heating sources.

The major difference is that you use a renewable fuel that produces an ash waste product.

This ash, which collects in an ash drawer, must be removed at regular intervals in order not to affect the efficiency or function of the stove.

By choosing our separator as an accessory, the ash handling work will be made much simpler.

You return the ash to nature by spreading it on lawns, thereby reducing the need for fertiliser. Biofuel combustion does not add to the carbon dioxide content in the atmosphere.

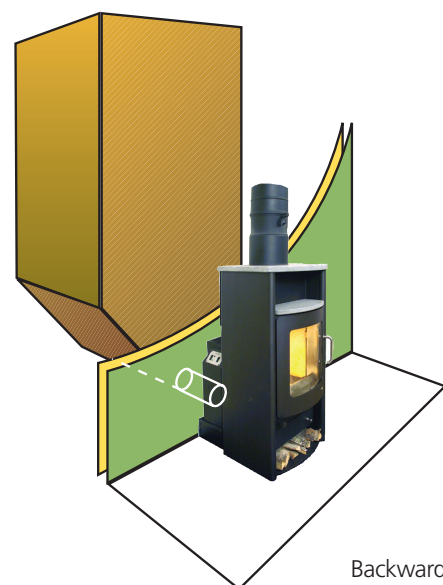

Backward mounted pellet store

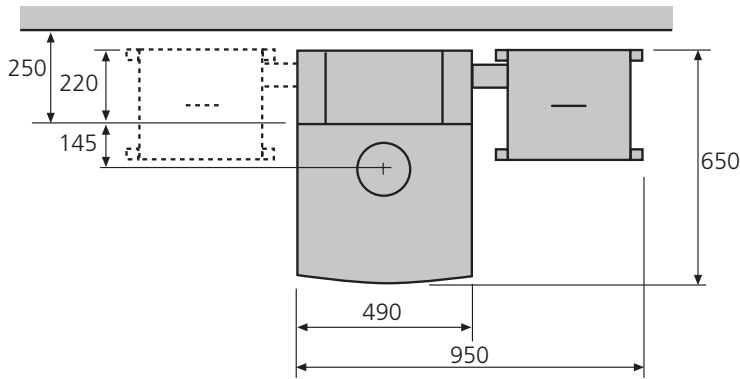

Side-mounted store, right or left-hand side

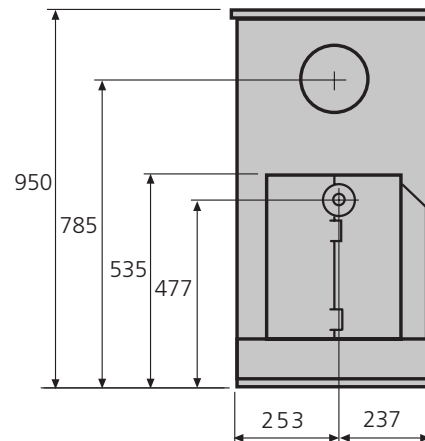

## Advice on biofuel – raw materials

The Tyr uses 6 mm or 8 mm wood pellets. The important factors are energy value, ash content, the volatile matter content, the environmental impact and, last but not least, the price. You should choose a fuel which has the lowest cost per unit of energy, taking into account the fuel's function in the boiler, its ash content and environmental impact.

## Approved specification for pellet fuel

Weight	600-750 kg/m <sup>3</sup>
Energy content	4.7-5.4 kWh/kg
Size / Diameter	6-8 mm
Size / Length	Note: max. 35mm
Moisture content	max. 12%
Ash content / Weight	<0.5% (sawdust pellets)
Fines content / Weight	max. 3%
Ash melting temp.	min. 1100°C

## Fuel fact (Example)

1 tonne of pellets is the equivalent of approx. 4,800 kWh of electric heat. How much you can replace with pellets by using a Tyr stove depends on the actual conditions in your house.

## Technical data for the Tyr

Feed output, pellets/firewood:	6 kW
Firewood load	max. 2 kg/h
Fuel store	from 65 litres
Weight (excl. store)	150 kg
Required chimney draught (with max. utilisation of the house's mechanical ventilation)	1 mm VP (-10 Pa)

Rear flue pipe conn.:	785 mm
Voltage connection:	230 VAC
Max. power requirement:	60 W
Noise level	44 dB

The stove must be connected to a  $\varnothing 150$  flue internally dimensioned and approved for 350° C flue gas temperature.

A damper must be installed.

We reserve the right to make changes to the dimensions and design.

## Control, regulation and monitoring

The Tyr burner is controlled by a thermostat placed in the room. The control device supplied for the stove then regulates the operation and monitors other functions.



EcoTec värmesystem AB, PO Box 2103,  
511 02 Skene, Sweden  
Tel. +46 (0)320 20 93 40 Fax. +46 (0)320 421 60  
info@ecotec.net